

Product datasheet

Specifications



7 inch wide screen, Basic model, 1 serial port, embedded RTC

HMIGXU3500

⚠ To be discontinued on: 31 Dec 2024

⚠ To be end-of-service on: 31 Dec 2025

⚠ To be discontinued

Main

Range Of Product	Harmony Easy GXU
Product Or Component Type	Advanced touchscreen panel
Display Type	LCD touch screen
Display Colour	65536 colours
Display Resolution	800 x 480 pixels WVGA
Display Size	7 inch

Complementary

Backlight Lifespan	20000 hours
[Us] Rated Supply Voltage	24 V DC
Software Designation	Vijeo Designer Basic configuration software
Memory Description	Internal, 32 MB for application Internal DDR, 128 MB Internal, 128 kB for backup
Integrated Connection Type	COM1 serial link: 9-way male SUB-D connector, RS422/RS485 USB type mini B
Cut-Out Dimensions	190 x 135 mm

Environment

Quality Labels	CE
Ambient Air Temperature For Operation	0...50 °C
Ambient Air Temperature For Storage	-20...60 °C
Ip Degree Of Protection	IP65 (front panel)

Packing Units

Unit Type Of Package 1	PCE
Number Of Units In Package 1	1
Package 1 Height	9.166 cm
Package 1 Width	18.001 cm
Package 1 Length	25.741 cm
Package 1 Weight	881 g
Unit Type Of Package 2	S04

Disclaimer: This documentation is not intended as a substitute for and is not to be used for determining suitability or reliability of these products for specific user applications

Number Of Units In Package 2	12
Package 2 Height	30 cm
Package 2 Width	40 cm
Package 2 Length	60 cm
Package 2 Weight	11585.5 g
Unit Type Of Package 3	P12
Number Of Units In Package 3	144
Package 3 Height	95 cm
Package 3 Width	80 cm
Package 3 Length	120 cm
Package 3 Weight	148026 g

Sustainability

Green Premium™ label is Schneider Electric's commitment to delivering products with best-in-class environmental performance. Green Premium promises compliance with the latest regulations, transparency on environmental impacts, as well as circular and low-CO₂ products.

Guide to assessing product sustainability is a white paper that clarifies global eco-label standards and how to interpret environmental declarations.

[Learn more about Green Premium >](#)

[Guide to assess a product's sustainability >](#)

Resource performance

 Upgradeable Through Digital Modules

Well-being performance

 Mercury Free

 Rohs Exemption Information [Yes](#)

Reach Regulation [REACH Declaration](#)

Eu Rohs Directive Pro-active compliance (Product out of EU RoHS legal scope)

China Rohs Regulation [China RoHS declaration](#)

Dimensions Drawings

Dimensions

External Dimensions

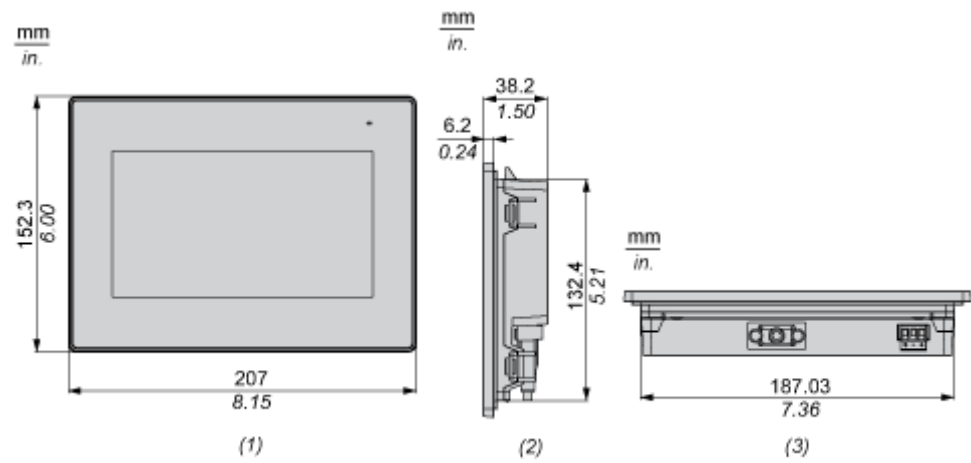

- (1) Front
- (2) Right
- (3) Bottom

Installation with Installation Fasteners

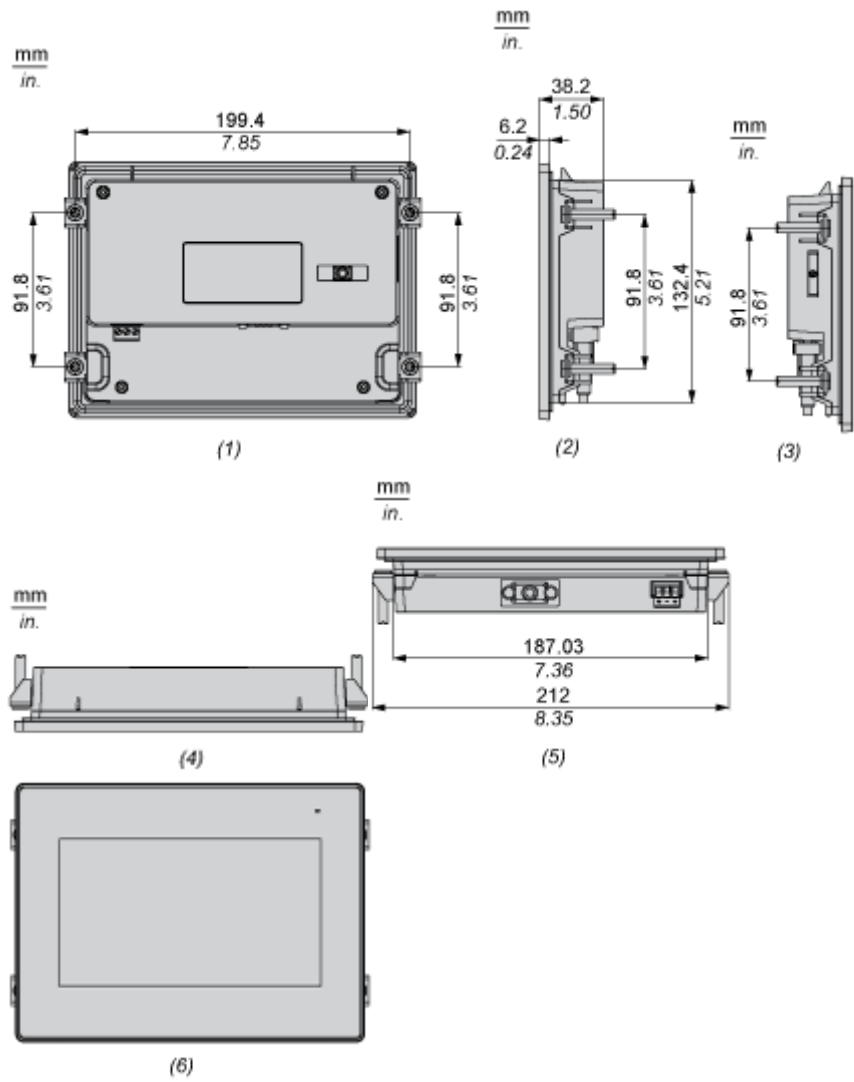

- (1) Rear
- (2) Right

- (3) Left
- (4) Top
- (5) Bottom
- (6) Front

Dimensions with Cables

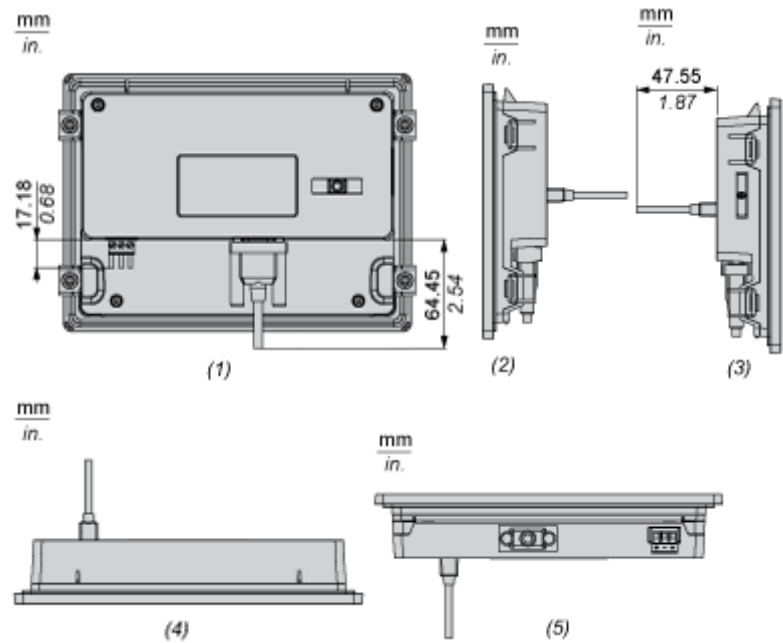

- (1) Rear
- (2) Right
- (3) Left
- (4) Top
- (5) Bottom

Mounting and Clearance

Mounting

Panel Cut Dimensions

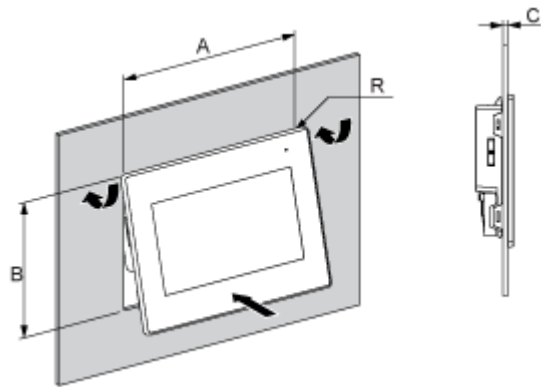

A		B		C		R	
mm	in.	mm	in.	mm	in.	mm	in.
190 \pm 1	7.48 \pm 0.04	135 \pm 0.7	5.31 \pm 0.03	1...5	0.04...0.19	3 max	0.12 max.

Installation Fasteners Dimensions

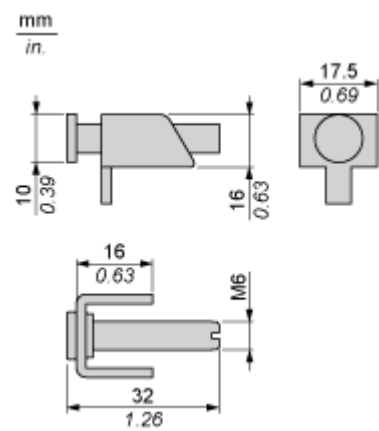

Installation Requirements

Mounting Angle

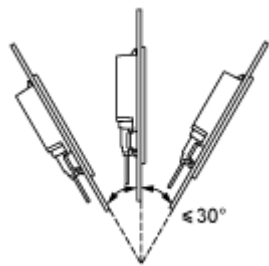

When installing the panel in a slanted position, and the panel face inclines more than 30°, the ambient temperature must not exceed 40 °C (104 °F).

Clearance

